



St Hugh's College  
UNIVERSITY OF OXFORD

# Dining Hall

Main Building

The Dining Hall is the heart of the College, and has been the centre of St Hugh's College main building since it was built in 1914. The building was extended in 1955 the Second World War where the College was requisitioned by the military for use as the Hospital for Head Injuries.

## Dining Hall

The traditional College Dining Hall is available for breakfast, lunches and served gala dinners which are all lovingly created by our team of talented chefs.

The room is set with banquet tables, a raised Head table, and leads directly onto our Rose Terrace which is the perfect location for drinks on a summers evening.

During term time this room is only available on Saturdays.

## Toilets

Toilet facilities, including an accesible toilet with baby changing facilities are located a short distance along the corridor.



	Theatre	Classroom	Boardroom	U Shape	Rounds	Cabaret	Banquet	Reception
<b>Main Building</b>								
Dining Hall	0	0	0	0	0	0	220	80

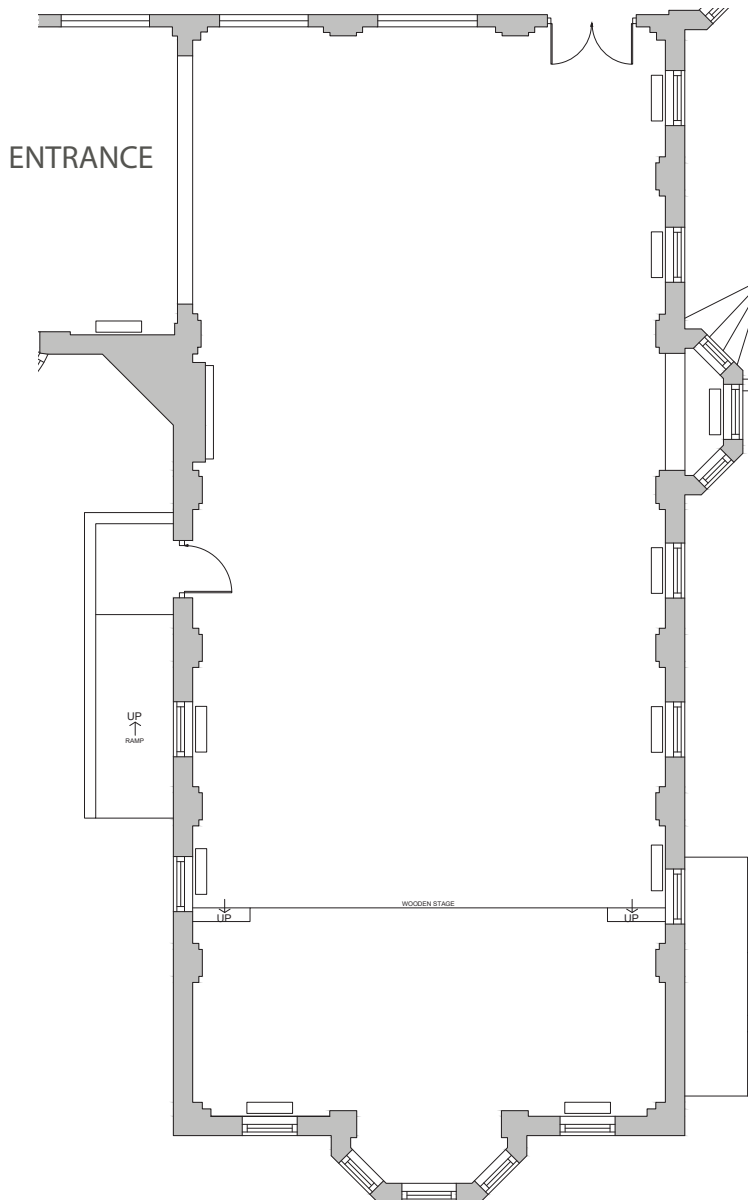

### Dimensions

Width: 9.3m

Length: 21.5m

### AV Equipment

- Sound system for speeches & background music
- Wireless microphone
- Option for lectern and microphone

### Key Features

- Large windows
- Direct access onto Rose terrace
- Traditional setting
- Long banquet tables with chairs
- Raised high/top table
- Stage area