



St Hugh's College  
UNIVERSITY OF OXFORD

# Maplethorpe Seminar Room

Maplethorpe Building

Completed in 2000, the building comprises of three light and airy event spaces, including Maplethorpe Hall, Maplethorpe Seminar Room and Maplethorpe Office. This self-contained facility also offers en-suite accommodation for residential guests outside of University term time.

## Maplethorpe Seminar Room

The Maplethorpe Seminar Room offers great meeting space for stand-alone meetings or as a breakout area for larger events in the Maplethorpe Hall.

## Catering

We serve refreshments and buffet lunches or dinners from the Seminar foyer, just outside the room, which is shown on the floor plan on the next page of this fact sheet.

## Toilets

Toilet facilities, including an accesible toilet, are located in the Canterbury Road foyer shown on the following floor plan. Access is either through the Maplethorpe Hall, or via the Canterbury Road foyer entrance if another event is in Maplethorpe Hall.



	Theatre	Classroom	Boardroom	U Shape	Rounds	Cabaret	Banquet	Reception
<b>Maplethorpe suite</b>								
Maplethorpe Seminar Room	60	30	30	24	50	48	60	60

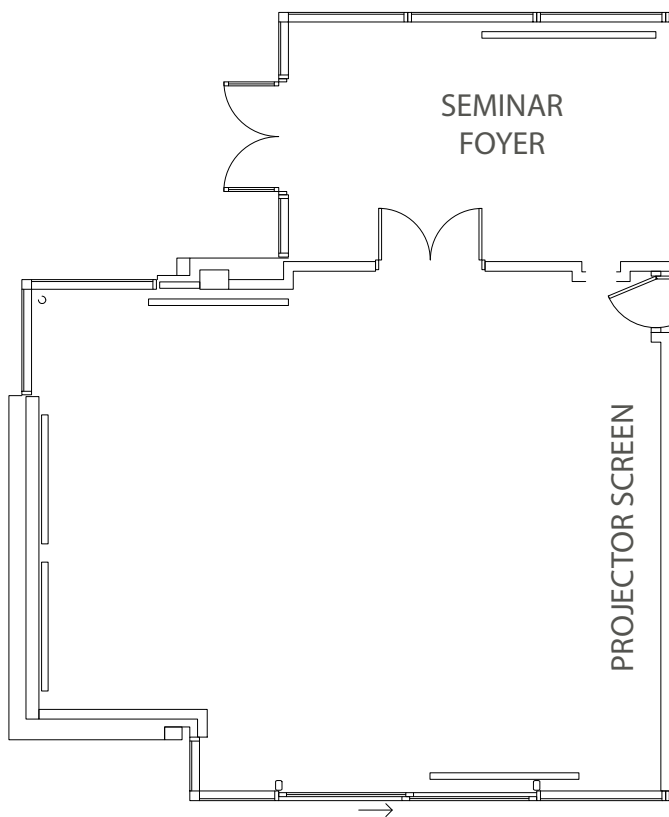
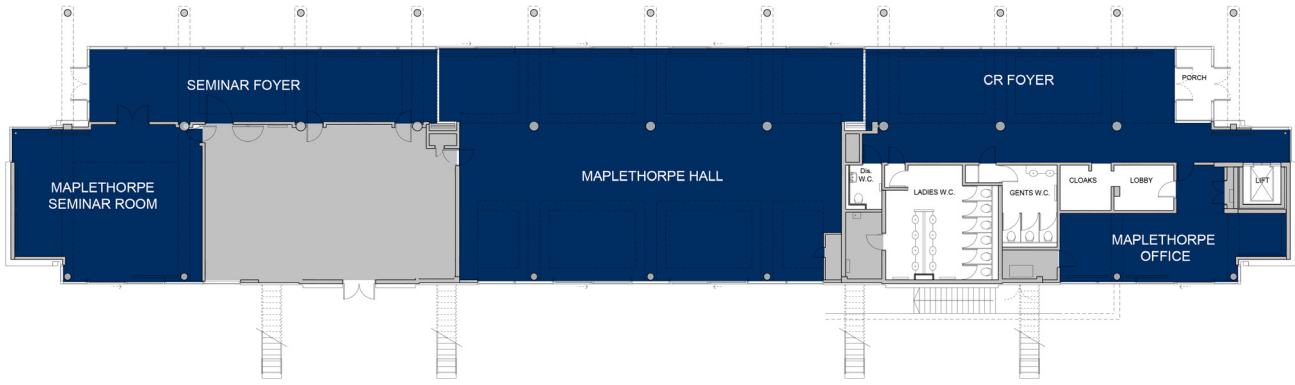

### Dimensions

Width: 8m  
 Length: 9.5m  
 Height: 2.75m

### AV Equipment

- Projector with VGA input
- Laptop (Windows & Microsoft Office)
- Conference sound system

### Key Features

- Large windows
- Direct garden access
- Complete flat level access
- Accessible toilet
- Flexible furniture layouts
- Conference & celebration use
- Removable stage
- Wifi access
- Fresh air circulation system
- Portable coat rails